

NOTE THIS DRAWING IS FOR GUIDANCE ONLY AND MUST NOT BE USED AS A PROPER WORKING DRAWING. FOR ENQUIRES ABOUT THE LIFT PLEASE CONTACT 0203 355 0523

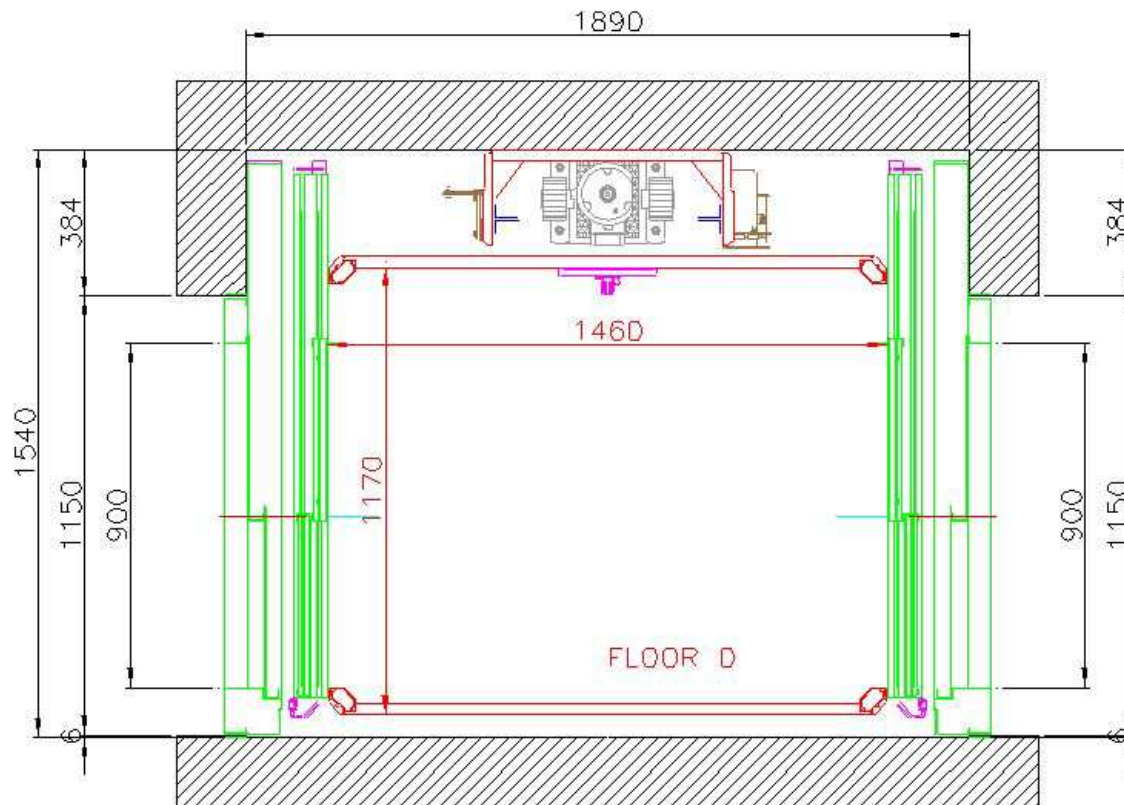

LIFT STD SPECIFICATION

- Load capacity - 320kg
- Drive system - Traction Belt
- Speed - 0.15 m/s
- Maximum number of stops - 5
- Maximum Travel - 14.6m
- Pit Depth - 120mm
- Headroom - 2600mm
- Power - 230V-mono AC – 50Hz
- Motor - 1.5 kW
- Cabin COP - Full height Vertical
- Car Controls - One Touch
- Landing Controls - One Touch
- Cabin Ceiling - LED bar
- Cabin Finish - Skin-plate
- Door Type - Telescopic
- Door Finish - RAL 7040
- Communication - Telephone

- Structure - Shaft by others
- Structure Finish - Built to withstand the loadings issued on job specific drawing.

Options

- LCD Display
- Voice Announcement
- Cabin Mirror
- Handrail
- Auto-dialer
- Numerous Cabin Finishes
- Stainless Steel Cabin/Landing doors
- 120min Fire rated doors



120 Bath Road, Harlington, Heathrow. UB3 5AN
 Telephone 0203 355 0523
 Email: info@premierplatformlifts.co.uk

ECO700 – Shaft by others -1460mm x 1170mm Through Entry/Exit – Telescopic doors		
DWG NO - 0002		REV - A
SCALE NTS	DATE 11/10/2011	DRAWN APG